

# Buying Guide:

## Clariflocculator

**Design using STAAD Pro:** Adroit's Clariflocculator (Rotating bridge) is designed using STAAD Pro software, as required by MPJNM. A properly designed bridge prevents excessive deflections, overhanging and is structurally designed to withstand the required design loads.

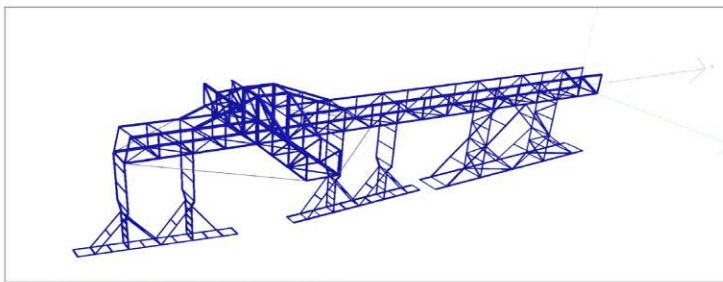

3D Rendered View (Input data was modified after picture taken)

**Thickness of Chequered Plate:** As per MPJNM Specifications, 8mm chequered sheet should be used for bridge walkway, OEM's often use 5mm sheet leading to non compliance of tender specification which has direct impact on weight of bridge hence price.

**Flocculator Paddles Design:** Flocculator paddles should be designed as per CPHEEO manual and the shaft design should be checked for bending & torsional stresses whereas OEM's often do not design flocculator paddles as per CPHEEO manual which lead to insufficient floc formation, and inefficient flocculator operation.

**Bridge Specifications:** As per MPJNM tender specification, the bridge must be 1.2 meters wide and the hand railing must be at least 1 meter high above the walkway. This is to ensure sufficient space for walking/mounting and conducting maintenance on bridge.

Other  
OEMs

adroit

